

BACK CREEK CHRISTIAN ACADEMY



Eighteen years ago, the dream of providing a unique, classical Christian education to children in the University City/Harrisburg area became a reality. With the assistance of Back Creek Presbyterian Church, Back Creek Christian Academy opened its doors with 8 children and 1 teacher. Since that first day, the school has grown to include Transitional Kindergarten through High School with students from different races, socio-economic backgrounds, religious traditions, and developmental abilities. BCCA graduated its first senior class in 2018. We are thankful that school and community growth have not altered Back Creek Christian's unwavering commitment to developing children who gracefully display and defend the Truth of the Gospel. Building on the firm foundation they received at Back Creek Christian Academy, our graduates and former students are sharing Christ in their colleges, neighborhoods, and the world.

Our current facilities are borrowed or leased, limiting our opportunity to "put down roots" and create a school for the future. Quite simply, Back Creek Christian has run out of space at our current location. The vision for growth and our desire to reach more students has led us to a new opportunity on the campus of Eastside Church. The Eastside campus provides the capacity to create a unique academy campus, with all grades located in one learning village. Not only will we own the school buildings (allowing us to modify to meet our learning needs), but our classrooms will be larger and dedicated to the specific educational offerings of the school. More excitingly, we will also have room to expand for the future! Phase one will establish this new facility, solely dedicated to educating children; equipping them for life with a classical Christian education.

The second phase of this journey will see the construction of a gymnasium on the new Back Creek Christian Academy at Eastside campus. This facility will be used to support athletic programs and physical education classes, as well as serve as the school cafeteria. While a significant effort, these facilities are vital to our mission of providing a high-quality educational experience to our families.

This dream is now becoming a reality. Through new partnerships, generous donations, and fervent prayers, the new campus is underway and should be completed by fall 2019. To accomplish this mission, we need you to support the "Putting Down Roots" campaign with your prayers and financial gifts. Back Creek Christian Academy is seeking the funds necessary to establish a permanent home. The need is significant and the situation urgent. This is our Call to Action: Please join us in this next, exciting chapter while we follow God in putting down roots!

BACK CREEK CHRISTIAN ACADEMY



Date founded: Founded in 1999, Back Creek Christian Academy is a 501 (c)(3) tax-exempt organization

Accreditation:
Association of Christian Schools International and AdvancED

Mission:
Back Creek Christian Academy strives to prepare students, faculty, parents and staff to use their unique gifts to serve God in an ever-changing world.

Vision:
The vision of Back Creek Christian Academy is to equip students to display and defend Truth.

Curricular approach:
A classically designed curriculum that emphasizes the Lordship of Christ over both their hearts and their minds.

Current location:
Campus of Back Creek Church
1827 Back Creek Church Rd., Charlotte, NC

New location:
Eastside Community Church
10132 Harrisburg Rd., Charlotte, NC 28215

School grades: Transitional Kindergarten – 12th grade

Current enrollment: 155
Capacity Potential for the New Campus: 300+

Total Staff: 35

Additional programs:
Special service for students with exceptionalities
Arts education
Extracurricular sports and clubs
Service learning opportunities

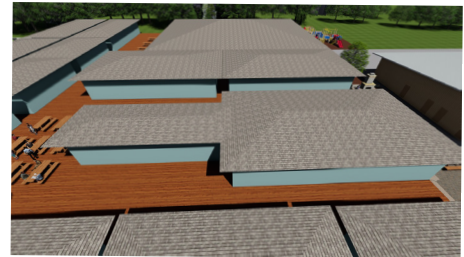

Demographics

Gender:

Male: 53%

Female: 47%

Racial Representation:

Caucasion: 55%

African American: 36%

Asian: 4%

Hispanic: 2%

Arabic/Other: 2%

BACK CREEK CHRISTIAN ACADEMY



PHASE 1 & PHASE 2

Phase 1 (\$600K): Relocate and renovate 27 classroom facility to Eastside Community.

Install composite decking for outdoor learning spaces and gathering spaces. Relocate playground.

Add additional parking and new road into campus. 15 passenger van for athletic transportation.

Phase 2 (1.6M): Construct onsite gymnasium with full service cafeteria.



How to make a tax-deductible donation to Back Creek Christian Academy:

Personal check written to Back Creek Christian Academy. Please mention the "Capital Campaign" in the memo line.

Checks can be mailed to:

Back Creek Christian Academy

Attn: Business Office

1827 Back Creek Church Road • Charlotte, NC 28213

Online donations via PayPal can be made through the school's website (bccaschool.org/support-bcca).

PayPal offers a number of funding options including credit and debit cards.

Stock donations - Please coordinate with the Business Office Manager, Dave Faber: 980-321-5372